



Wet Sandblaster

Models 30417-30422

FEATURES

- Ultra-lightweight, compact design for easy dust-free blasting.
- Stainless steel spray nozzle for long life.
- Durable tungsten carbide lined mixing nozzle and body for maximum service.
- Standard Sand Induction Hose Assembly permits visual inspection of sand draw.

COMMON SPECIFICATIONS

Maximum Pressure	3650 PSI	(250 BAR)
Maximum Temperature	195°F	(90°C)
Inlet Port	1/4" NPTF	(1/4" NPTF)
Sand Inlet Hose ID	1/2" NPT	(1/2" NPT)
Hose Tube & Probe Size	1/4" NPT	(1/4" NPT)
Weight — Housing	1.75 lbs.	(.79 kg)
— Housing, Probe, Hose	3.15 lbs.	(1.41 kg)
Length — Housing with Barb	5.12"	(130 mm)
— Probe	19.13"	(486 mm)

Wet Sandblaster is stamped with a European safety pressure. Use only at above specifications to assure proper wet sandblaster life and performance.

SELECTION: Select the sandblaster model by orifice size to match your system flow and pressure. The special Sand Induction Hose Assembly should be used to prevent collapsing during operation. For optimum performance the **sand inlet hose should not exceed the 25 feet included in the assembly.**

INSTALLATION: For best results the sand unit should be connected to a quality high pressure water source. A pressure gauge should be installed on the system to

SPECIFICATIONS

	U.S. Measure	Metric Measure
MODEL 30417		
Max. Flow	3.8 GPM	(14.5 L/M)
Nozzle Orifice	0.047"	(1.2 mm)
Sand Flow	6.0-9.0 lb/min.	(2.7-4.0 kg/min)
MODEL 30418		
Max. Flow	5.1 GPM	(19.5 L/M)
Nozzle Orifice	0.055"	(1.4 mm)
Sand Flow	6.5-10.0 lb/min.	(2.9-4.5 kg/min)
MODEL 30419		
Max. Flow	6.0 GPM	(23 L/M)
Nozzle Orifice	0.059"	(1.5 mm)
Sand Flow	7.0-11.0 lb/min.	(3.1-5.0 kg/min)
MODEL 30420		
Max. Flow	6.5 GPM	(25 L/M)
Nozzle Orifice	0.063"	(1.6 mm)
Sand Flow	7.5-13.0 lb/min.	(3.4-5.9 kg/min)
MODEL 30421		
Max. Flow	7.6 GPM	(29 L/M)
Nozzle Orifice	0.070"	(1.8 mm)
Sand Flow	8.5-13.0 lb/min.	(3.8-5.9 kg/min)
MODEL 30422		
Max. Flow	9.1 GPM	(34 L/M)
Nozzle Orifice	0.078"	(2.0 mm)
Sand Flow	8.5-13.0 lb/min.	(3.8-5.9 kg/min)

monitor system pressure as performance of the sandblaster is directly affected by the pressure of the system. A regulator or unloader must be installed in the pump discharge line of any system with a shut-off gun to handle by-pass liquid when the gun is shut off. Connect one end of the sand intake hose to sand siphon probe, place probe into sand supply and attach the other end to the hose connection tube at the body. Connect the sandblaster body to any 1/4" lance with 3500 PSI rating.

(continued on back)

“Customer confidence is our greatest asset”

EXPLODED VIEW

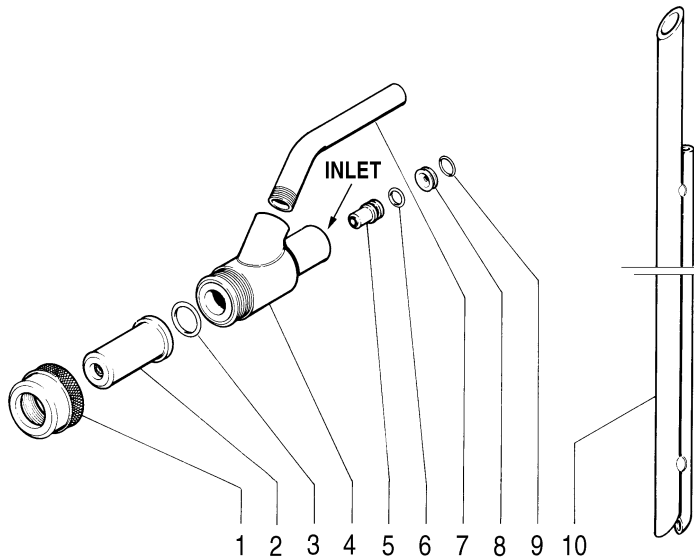

PARTS LIST

ITEM	P/N	MATL	DESCRIPTION	QTY
1	32064	BB	Retainer, Nozzle	1
2	33013	BB	Nozzle, Mixing, Tungsten Carbide Lined	1
3	33014	NBR	O-Ring, Mixing Nozzle - 70D	1
4	—	—	Body, Tungsten Carbide Lined (1/4")	1
5	31048	S	Nozzle (1.2 mm) SS w/O-Ring	1
	31049	S	Nozzle (1.4 mm) SS w/O-Ring	1
	31050	S	Nozzle (1.5 mm) SS w/O-Ring	1
	31056	S	Nozzle (1.6 mm) SS w/O-Ring	1
	31058	S	Nozzle (1.8 mm) SS w/O-Ring	1
	31068	S	Nozzle (2.0 mm) SS w/O-Ring	1
6	—	NBR	O-Ring, Spray Nozzle	1
7	34006	STL	Elbow, Bent	1
8	33217	BB	Insert	1
9	33216	NBR	O-Ring, Insert	1
10	33016	STL	Probe, Sand Siphon	1
—	34101	PVC	• Hose (1/2"x25')	1
—	34102	—	• Clamps, Hose (1/2")	2
—	30430	—	Sand Induction Hose Assembly (1/2"x25') (•Included in Assy)	1

MATERIAL CODES (Not Part of Part Number): BB=Brass
NBR=Medium Nitrile (Buna-N) PVC=PVC S=304SS STL=Steel

⚠ WARNING

Severe injury can occur with high pressure spray.
Do not allow spray to contact any part of body.

WARRANTY

90 Day Warranty

Refer to complete CAT PUMPS Warranty for further information.

OPERATION: Start the high pressure system. Open trigger on gun to assure system is operating properly. When the sand unit is operating efficiently, there will be a smooth and continuous flow of sand through the nozzle. The pressure and flow rate through the spray nozzle are the factors that determine the rate of sand flow. See **Performance Chart**. If the spray nozzle is chosen to give the maximum pressure and flow rate possible for the pump, the rate of sand flow will also be at maximum. Keep sand supply dry for best performance.

CAUTION

Adequate safety equipment and clothing must be worn during operation of the wet sandblaster.

PERFORMANCE CHART

Model	Spray Nozzle Orifice	Approximate flows at selected pressures					
		1000	1500	2000	2500	3000	3500
30417	1.2 mm	2.0	2.5	2.8	3.2	3.5	3.8
30418	1.4 mm	2.8	3.2	3.9	4.4	4.8	5.1
30419	1.5 mm	3.2	3.9	4.5	5.0	5.5	6.0
30420	1.6 mm	3.5	4.2	4.9	5.5	6.0	6.5
30421	1.8 mm	4.1	4.9	5.7	6.4	7.0	7.6
30422	2.0 mm	4.6	5.6	6.5	7.4	8.3	9.1

SAND SUPPLY

SURFACE	SUGGESTED SAND TYPE
Rust	Angular 16-50
Metal Scale	Round 20-40
Painted Metal	Round Silica 20-40
Painted Masonry	Round River 20-40
Painted Wood	Round 20-40

TROUBLESHOOTING

No Sand:

- Plugged sand probe
- Clear obstruction in sand probe.
- Wet sand
- Remove mixing nozzle and inspect mixing chamber.
- Low vacuum
- Dry or replace sand.
- Check for air leak in system.

Not enough sand:

- Low water pressure
- Check water supply to pump, nozzle size and RPM of pump.
- Collapsed hose
- Use reinforced hose. Remove any obstruction.
- Hot water reduces efficiency
- Optimum performance obtained with cold water.
- Partially plugged sand probe
- Remove any restriction from sand probe inlet. Use dry sand.
- Restricted sand flow
- Increase diameter of hose. Recommend 1/2" ID, Maximum 25 ft.

Products described hereon are covered by one or more of the following U.S. patents 3558244, 3652188, 3809508, 3920356, 3930756 and 5035580

World Headquarters

CAT PUMPS

1681 - 94th Lane N.E. Minneapolis, MN 55449-4324

Phone (763) 780-5440 — FAX (763) 780-2958

e-mail: sales@catpumps.com

www.catpumps.com

International Inquiries

FAX (763) 785-4329

e-mail: intlsales@catpumps.com



"The World's Most Dependable Pumps"

CAT PUMPS (U.K.) LTD.

1 Fleet Business Park, Sandy Lane, Church Crookham, Fleet

Hampshire GU52 8BF, England

Phone Fleet 44 1252-622031 — Fax 44 1252-626655

e-mail: sales@catpumps.co.uk

N.V. CAT PUMPS INTERNATIONAL S.A.

Heiveldekens 6A, 2550 Kontich, Belgium

Phone 32-3-450.71.50 — Fax 32-3-450.71.51

e-mail: cpi@catpumps.be www.catpumps.be

CAT PUMPS DEUTSCHLAND GmbH

Buchwiese 2, D-65510 Idstein, Germany

Phone 49 6126-9303 0 — Fax 49 6126-9303 33

e-mail: catpumps@t-online.de www.catpumps.de